

# Series MC take-off blocks

Ports G1/4 and G1/2  
Modular

- » Compact design
- » Available with or without VNR (no return valve)



The take-off blocks, when equipped with a no return valve, allow the use of non lubricated air and should be inserted between the regulator and the lubricator. If mounted as last element, they should be assembled with terminal flanges.

## GENERAL DATA

<b>Construction</b>	modular, compact
<b>Materials</b>	zama, NBR, technopolymer
<b>Ports</b>	G1/4 G1/2
<b>Weight</b>	kg 0,232 kg 0,379
<b>Take off ports</b>	G1/4 G1/2
<b>Mounting</b>	in- line or wall mounting (in any position)
<b>Operating temperature</b>	-5°C ÷ 50°C (with the dew point of the fluid lower than 2°C at the min. working temperature)
<b>Finishing</b>	enamelled
<b>Operating pressure</b>	0 ÷ 16 bar
<b>Nominal flow ( 6 bar ΔP 1bar )</b>	MC1-B = 4080 NI/min MC1-B-VNR = 2350 NI/min MC2-B = 8400 NI/min MC2-B-VNR = 5600 NI/min
<b>Fluid</b>	Compressed air

**CODING EXAMPLE**

<b>MC</b>	<b>2</b>	-	<b>B</b>	-	<b>VNR</b>
<b>MC</b>	SERIES				
<b>2</b>	SIZE: 1 = G1/4 2 = G1/2				
<b>B</b>	B = TAKE OFF BLOCK				
<b>VNR</b>	VERSION: = standard VNR = with no return valve				

SERIES MC TAKE-OFF BLOCKS

**Take off blocks Series MC**



BL01 = take-off block  
BL02 = take-off block with VNR

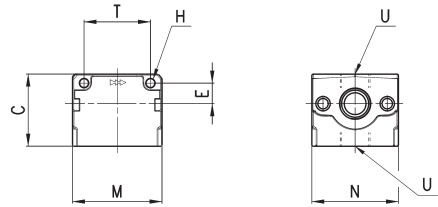
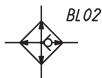

Mod.	C	H	E	M	N	T	U
MC1-B	43	4,5	11	45	45	35	G1/4
MC1-B-VNR	43	4,5	11	45	45	35	G1/4
MC2-B	50	5,5	14	62	60	46	G1/2
MC2-B-VNR	50	5,5	14	62	60	46	G1/2