

Mini Ball Valves

Connections: 1/8, 1/4, 3/8, 1/2

Our range of Mini Ball Valves offers a wide variety of choices for the design engineer.

6

Part Number: 3830*
Lever - Female/Female

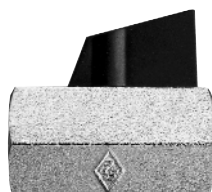

Part Number: 3831*
Lever - Male/Female

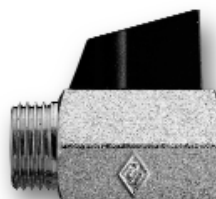

Part Number: 3730*
Lever - Female/Female



Part Number: 3731*
Lever - Male/Female



Part Number: 3860*
Screwdriver - Female/Female



Part Number: 3861*
Screwdriver - Male/Female

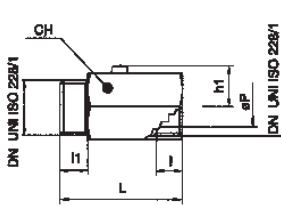
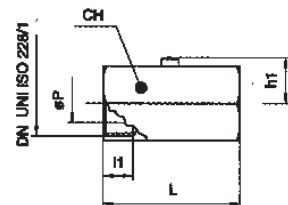
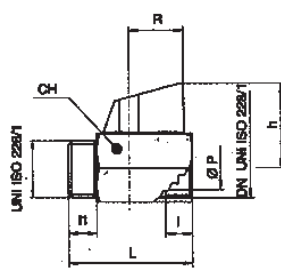
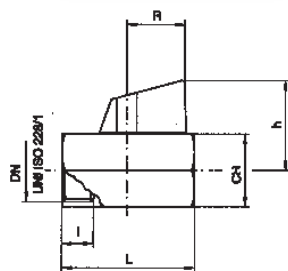

Dimensions (mm)

	ØP	C/H	I	L	h	h1	R	Kv
*1/8	8	21	8	41	29	13.8	20.5	4.3
*1/4	8	21	10	41	29	13.8	20.5	4.3
*3/8	8	21	10	41	29	13.8	20.5	2.7
*1/2	10	25	11	46	31	15.8	20.5	5.4

Technical Data

Media

Most non-corrosive liquids and gases including air, water and fuels

Operating Pressure

10 bar (147 p.s.i.)

Operating Temperature

-20°C to +90°C (detail of valves for higher temperatures available on request)

Flow Rate

Flow rates stated in Kv: Flow coefficient in m³/h at differential pressure of 100kPa

Threads

UNI ISO 228/1

Materials

Body: Brass, chrome plated, types 3730 and 3731 polished chrome plated

Handle: Plastic, types 3830 and 3831 black, types 3730 and 3731 plastic chromed

Ball: Brass, chrome plated

Main Seal: PTFE

Stem Seal: NBR. Viton on request

Actuation Details

90° rotation of lever

We recommend that the valve is used in either the fully open or fully closed position. In addition, the valve should be actuated at least twice a year

Additional Options

NPT available on request

Special Requests

For assistance, contact our technical office or your local Camozzi distributor.