

3-wire extension with M8 3-pin male / female connector

Non shielded

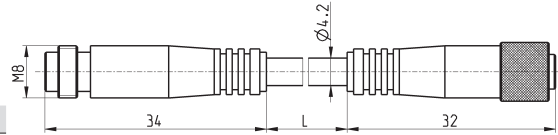

Mod.	cable length "L" (m)
CS-DW03HB-C250	2,5
CS-DW03HB-C500	5

Adapters Mod. S-CST-01 for Series CST-CSH-CSG sensors, V-slot

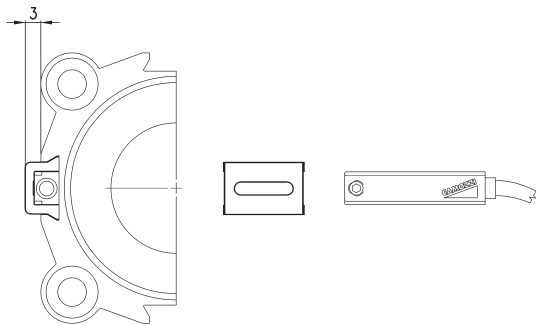

Mod.	Series QP-QPR cylinders	Series 50 cylinders
S-CST-01	Ø 20 ÷ 100	Ø 32 ÷ 80

Adapters Mod. S-CST-02..21 for Series CST-CSH-CSG sensors

- Materials:
- stainless steel and technopolymer (S-CST-05÷12)*
 - technopolymer (S-CST-02÷04)
 - technopolymer (S-CST-18÷21)

* Not suitable for use with Series CSG sensors



S-CST-02+04 S-CST-18+21

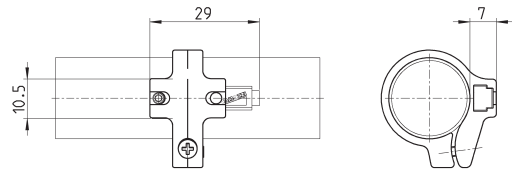

S-CST-05+12

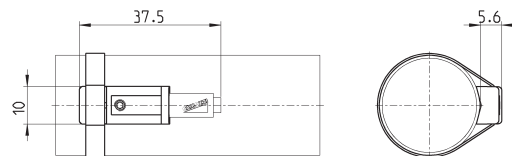

Mod.	Cylinders Series	Ø
S-CST-02	24-25-27	16
S-CST-03	24-25-27	20
S-CST-04	24-25-27	25
S-CST-05	94, 95	16-20-25 (94), 16-20 (95)
S-CST-06	90-92-97, 95	32 (90-92-97), 25 (95)
S-CST-07	90-92-97	40
S-CST-08	90-92-97	50
S-CST-09	90-92-97	63
S-CST-10	90	80
S-CST-11	90	100
S-CST-12	90	125
S-CST-18	27-42	32
S-CST-19	27-42	40
S-CST-20	27-42	50
S-CST-21	27-42	63