

Lockable Safety Ball Valve

Connections: 1/4, 3/8, 1/2, 1

Our lockable safety ball valve is for use as an on-off valve for pneumatic systems. In off position, vent hole in valve body allows air to be exhausted. In the off position, downstream air is exhausted to atmosphere through a small vent hole in the valve body. Locking feature allows maintenance and setting activities to be carried out safely on the system and prevents air supply being reactivated inadvertently.

Part Number: S93*



Technical Data

Media

For use as an on-off valve for pneumatic systems

Operating Pressure

0 to 16 bar

Operating Temperature

-20°C to +90°C

Threads

UNI ISO 7/1

Materials

Body: Brass, nickel plated

Ball: Brass, hard chrome

Seals: PTFE

Handle: Steel zinc plated, blue plastic coated

Direction flow: As indicated by arrow

Special Requests

For assistance, contact our technical office or your local Camozzi distributor.

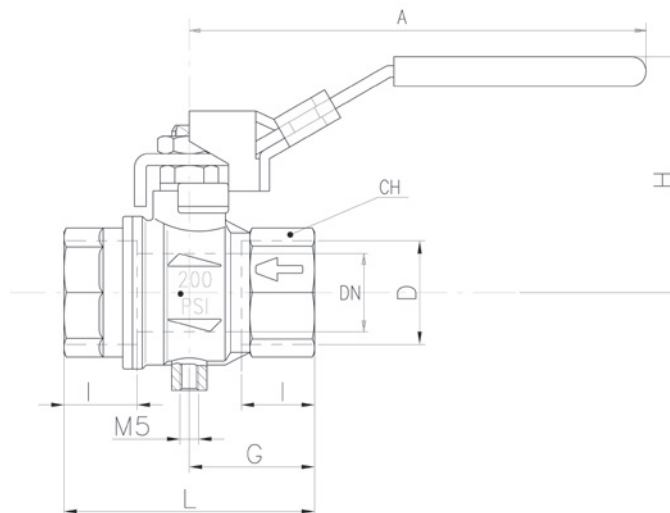

✓ Ex Stock

✎ UK Assembly

☎ Please Call Sales Office

	D(inch)	DN(mm)	J(mm)	L(mm)	G(mm)	A(mm)	H(mm)	AF(mm)
*B00 ✓	1/4	8	12	45	22.5	96	47.5	20
*C00 ✓	3/8	9.5	12	45	22.5	96	47.5	20
*D00 ✓	1/2	15	15.5	59	29.5	96	52	25
*F00 ✓	1	24	21	81	40.5	117	63.5	40