

## Brass Ball Valves - with ISO Pad

Connections: 1/4, 3/8, 1/2, 3/4, 1, 1 1/4, 1 1/2, 2, 2 1/2, 3, 4

Full bore brass ball valves with ISO 5211 mounting pad for direct mounting of pneumatic/electric actuators for on-off applications of most non-corrosive media. Body seals energised with Viton 'O' rings.

Only for actuation - no lever available

Part Number: 2500\*

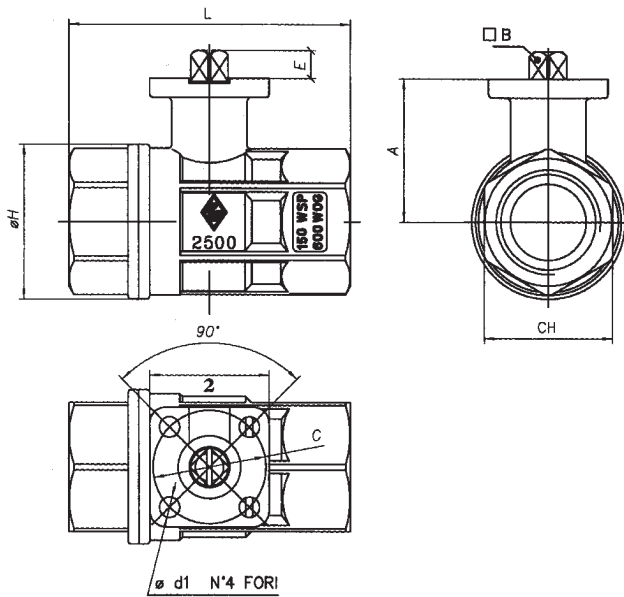
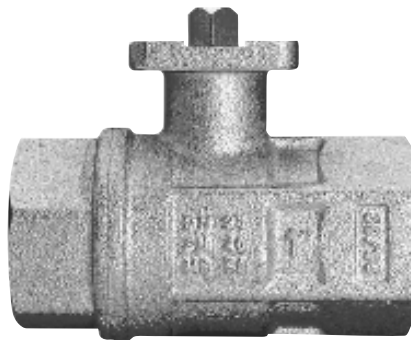

Dimensions (mm) and Pressures

	DN	2	A	B	C	d1	E	H	L	Kv	PN	Torque
*1/4	8	38	32.5	9	36	6	9	33.5	67	5.4	40	6 NM
*3/8	10	38	32.5	9	36	6	9	33.5	67	6	40	6 NM
*1/2	15	38	32.5	9	36	6	9	33.5	67	16.3	40	6 NM
*3/4	20	38	34.5	9	36	6	9	40	76	29.5	40	6 NM
*1	25	38	45.5	9	36	6	9	49	90	43	40	6 NM
*1 1/4	32	38	59	9	36	6	9	58.5	102	89	40	6 NM
*1 1/2	40	50	64	11	50	7	11	73	114	230	40	17 NM
*2	50	50	73.25	11	50	7	11	91.5	138	265	40	17 NM
*2 1/2	65	70	88.5	14	70	9	15	114.5	165	540	25	31 NM
*3	80	70	98	14	70	9	15	136	188	873	16	31 NM
*4	100	70	116.5	17	70	9	17.5	166	225	1390	16	73 NM

### Technical Data

#### Media

Most non-corrosive liquids and gases including air, water, solvents, fuels and propane

#### Operating Pressure

See chart

#### Operating Temperature

-20°C to +160°C

#### Flow Rates

Flow rates stated in Kv: Flow coefficient in m<sup>3</sup>/h at differential pressure of 100kPa

#### Threads

UNI ISO 7/1

#### Materials

Body: Brass, nickel plated  
Ball: Brass, chrome plated  
Seals: PTFE with Viton 'O' Ring  
Size: 1/4" to 4" UNI ISO 7/1

#### Actuation Details

Refer to chart for torque and pad details

#### Additional Options

NPTF - Series 250N



Available with spring return (dead mans) lever.



Available with Pneumatic Actuators



Available with Electric Actuators

#### Special Requests

For assistance, contact our technical office or your local Camozzi distributor.