

Silencers Series 2931

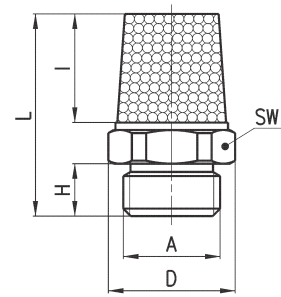

DIMENSIONS										
Mod.	A	D	H	I	L	SW	Max. Oper. Pressure	Flow rate NI/Min	Noise db (A)	
2931 M5	M5	7,7	4	8	16,5	7	10	450	69	
2931 M7	M7	9	5	8,5	20	8	10	1130	76	
2931 1/8	G1/8	13	4,5	13	21	12	10	1927	88	
2931 1/4	G1/4	16,2	6	16,5	27	15	10	3200	86	
2931 3/8	G3/8	20	7	23	35,5	19	10	4560	81	
2931 1/2	G1/2	24,5	8	28	42	23	10	6800	87	
2931 3/4	G3/4	32	9	37	54	30	10	9600	84	
2931 1	G1	38,5	11	47	67	36	10	10800	86	

SIL 1



Silencers Series 2938

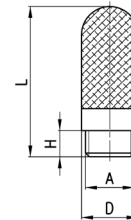

DIMENSIONS								
Mod.	A	D	H	L	Max. Oper. Pressure	Flow rate NI/Min	Noise db (A)	
2938 M5	M5	6,5	4,1	23	10	546	67	
2938 1/8	G1/8	12,5	5,7	34	10	1441	75	
2938 1/4	G1/4	15,5	7	42,5	10	2752	79	
2938 3/8	G3/8	18,5	11,5	67,5	10	4735	73	
2938 1/2	G1/2	23,5	11	77	10	8534	86	

SIL 1



Operating temperature:
- 40 / + 80 °C

Silencers Series 2939



Operating temperature:
- 40 / + 80 °C

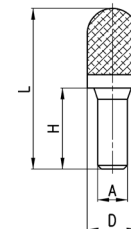

DIMENSIONS							
Mod.	A	D	H	L	Max. Oper. Pressure	Flow rate NI/Min	Noise db (A)
2939 4	4	7	16	32	10	335	80
2939 6	6	12,5	20,5	45	10	632	79 *
2939 8	8	13,5	21,5	43,5	10	1229	89 *
2939 10	10	15,5	26,5	57,5	10	2650	87 *

SIL 1

